

# The Knowl Century Mill

2-bedroom home, sleeps 4



2 | 

1 | 

1 | 



Artist's impression

## Key features

- Two double bedrooms
- Downstairs W.C.
- Open plan kitchen and dining room
- Separate living room
- Driveway parking



## The Knowl

Available plots

61, 64, 65, 66, 67,  
74, 75, 76, 77, 82,  
83 or 84

**George Street, Farnworth, BL4 9QT**

A collection of 106 beautifully designed new homes

# The Knowl Century Mill

2-bedroom home, sleeps 4

**Ground floor**

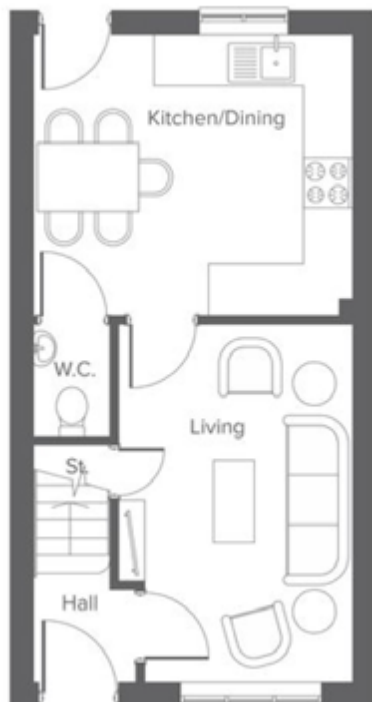

**First floor**



Room	Metric	Imperial
Kitchen/Dining	4.22 x 3.6	13'10" x 11'9"
Living	3.08 x 4.89	10'1" x 16'0"
W.C.	1.06 x 1.43	3'5" x 4'8"

Room	Metric	Imperial
Bedroom 1	4.22 x 3.09	13'10" x 10'1"
Bedroom 2	4.22 x 3.00	13'10" x 9'10"
Bathroom	2.13 x 2.01	6'11" x 6'7"

Total size **68.3 m<sup>2</sup> / 735.1 ft<sup>2</sup>**



## Get in touch

 01204 896180

 [yourhousinggroup.co.uk](https://www.yourhousinggroup.co.uk)

 @yourhousing

 @Your\_Housing

 yourhousinggroup

 yhgtv