

The Cholmondeley Charnock Grove



2-bedroom home, sleeps 3

2 | 

1 | 

1 | 



Artist's impression

Key features

- Spacious double bedroom
- Good sized single bedroom
- Open plan kitchen/ dining/ living
- Patio doors to rear garden
- Three-piece family bathroom



The Cholmondeley

Available plots

59, 60, 61, 62, 63,
64 or 65

Charter Lane, Charnock Richard, PR7 5LZ
A collection of 76 beautifully designed new homes

The Cholmondeley Charnock Grove

2-bedroom home, sleeps 3

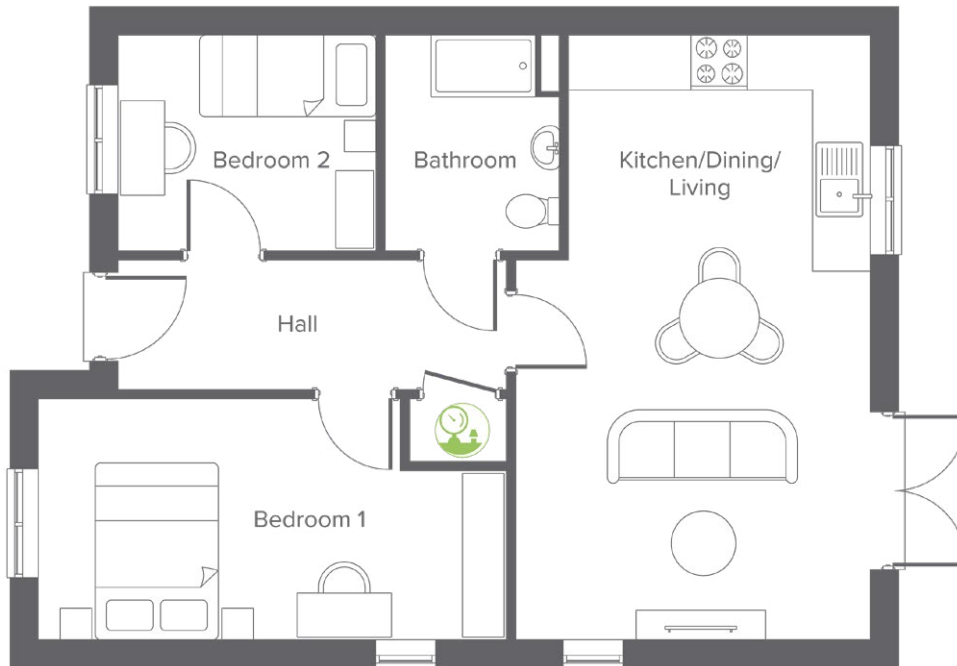

Ground floor

| Ground Floor | Metric | Imperial |
|-----------------------|-------------|---------------|
| Kitchen/Dining/Living | 6.95 x 4.04 | 22'9" x 13'3" |
| Bedroom 1 | 2.73 x 5.33 | 8'11" x 17'5" |
| Bedroom 2 | 2.51 x 2.94 | 8'2" x 9'7" |
| Bathroom | 2.46 x 1.97 | 8'0" x 6'5" |

Total size **62.6m² / 674ft²**

 Room for Air source heat pump/water tank

Get in touch

 01257 650614

 yourhousinggroup.co.uk

 @yourhousing

 yourhousinggroup