

# The Arundel Charnock Grove



3-bedroom home, sleeps 5

3 | 

1 | 

1 | 



Artist's impression

## Key features

- Two double bedrooms
- Downstairs W.C.
- Open plan kitchen and dining room
- Separate living room
- Driveway parking



**The Arundel**  
Available plots  
44

**Charter Lane, Charnock Richard, PR7 5LZ**  
A collection of 76 beautifully designed new homes

# The Arundel Charnock Grove

3-bedroom home, sleeps 5

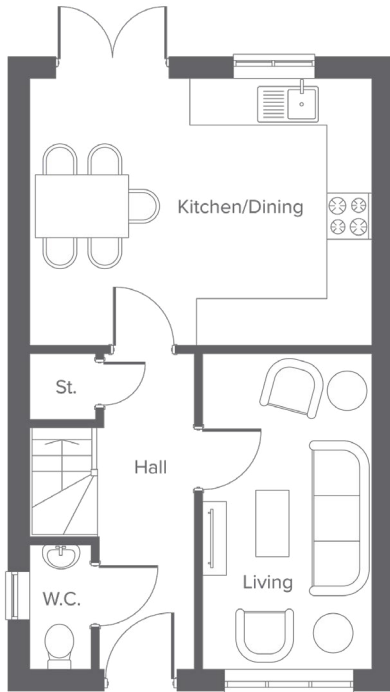

**Ground floor**

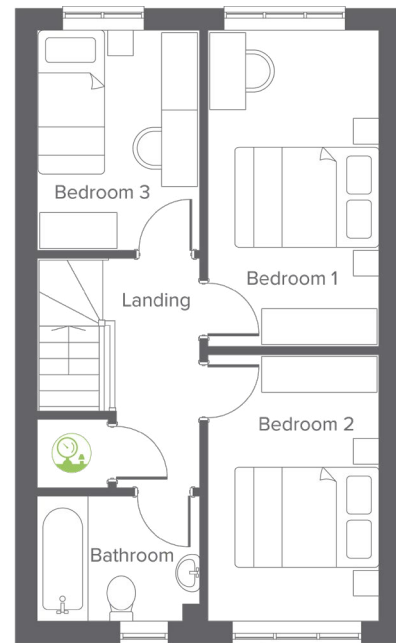

**First floor**

Ground Floor	Metric	Imperial
Kitchen/Dining	4.82 x 3.73	15'9" x 12'2"
Living	2.36 x 4.40	7'8" x 14'5"
W.C.	0.88 x 1.74	2'10" x 5'8"

First Floor	Metric	Imperial
Bedroom 1	2.39 x 4.42	7'10" x 14'6"
Bedroom 2	2.39 x 3.72	7'10" x 12'2"
Bedroom 3	2.32 x 3.07	7'7" x 10'0"
Bathroom	2.34 x 1.77	7'8" x 5'9"

Total size **79.4m<sup>2</sup> / 855.5ft<sup>2</sup>**

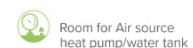

## Get in touch

 01257 650614

 [yourhousinggroup.co.uk](https://www.yourhousinggroup.co.uk)

 @yourhousing

 yourhousinggroup